

MBN TYPE

C / H

MBN-C / MBN-H

MBN 7, MBN 9, MBN 12

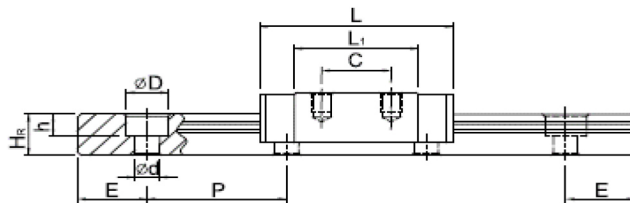
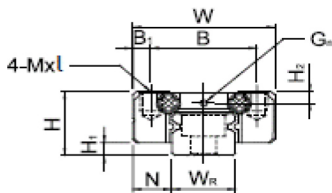

MBN 15

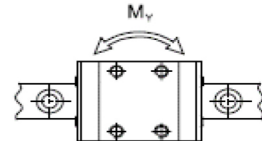
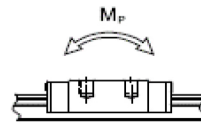
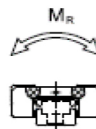
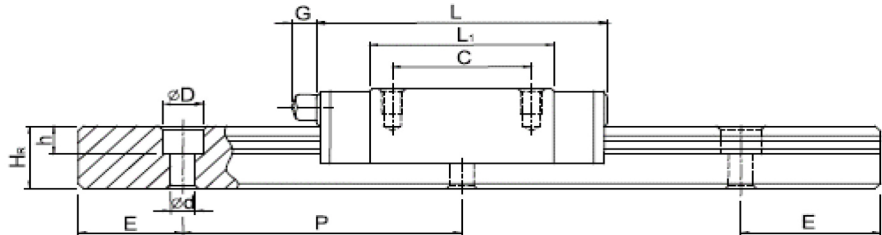
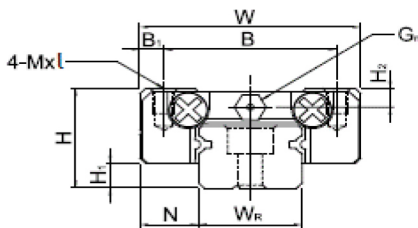

Model	Dimensions of Assembly (mm)				Dimensions of Block (mm)										Dimensions of Rail (mm)						Mounting Bolt for Rail (mm)	Dyn. Load C(kN)	Static Load C1(kN)	Static Rated Moment			Weight	
	H	H1	N	W	B	B1	C	L1	L	G	G2	Mxl	H2	WR	HR	D	h	d	P	E				MR kN-m	MP kN,m	MY kN-m	Block kg	Rail kg/m
MBN 7C	8	1.5	5	17	12	2.5	8	13.5	22.5	-	Ø1.2	M2x2.5	1.5	7	4.8	4.2	2.3	2.4	15	5	M2x6	0.98	1.24	4.70	2.84	2.84	0.010	0.22
MBN 7H							13	21.8	30.8													1.86	2.55	11.76	7.35	7.35	0.016	
MBN 9C	10	2	5.5	20	15	2.5	10	18.9	28.9	-	Ø1.4	M3x3	1.8	9	6.5	6	3.5	3.5	20	7.5	M3x8	1.86	2.55	11.76	7.35	7.35	0.016	0.38
MBN 9H							16	29.9	39.9													2.55	4.02	19.60	18.62	18.62	0.026	
MBN 12C	13	3	7.5	27	20	3.5	15	21.7	34.7	-	Ø2	M3x3.5	2.5	12	8	6	4.5	3.5	25	10	M3x8	2.84	3.92	25.48	13.72	13.72	0.034	0.65
MGN 12H							20	32.4	45.4													3.72	5.88	38.22	36.26	36.26	0.054	
MBN 15C	16	4	8.5	32	25	3.5	20	26.7	42.1	4.5	M3	M3x4	3	15	10	6	4.5	3.5	40	15	M3x10	4.61	5.59	45.08	21.56	21.56	0.059	1.06
MBN 15H							25	43.4	58.8													6.37	9.11	73.50	57.82	57.82	0.092	